



USER MANUAL

Professional audio mixer



Factory address

Jagtvej 153,203:
2200 Copenhagen,Denmark
+45 65 74 65 16

UK Sales Office address:

128 City Road, London, United Kingdom, EC1V 2NX
+44 2039088010

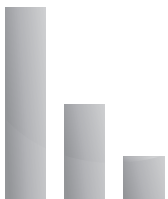

www.nordlyslight.com

www.nordlyslight.com

CONNECTION INSTRUCTIONS

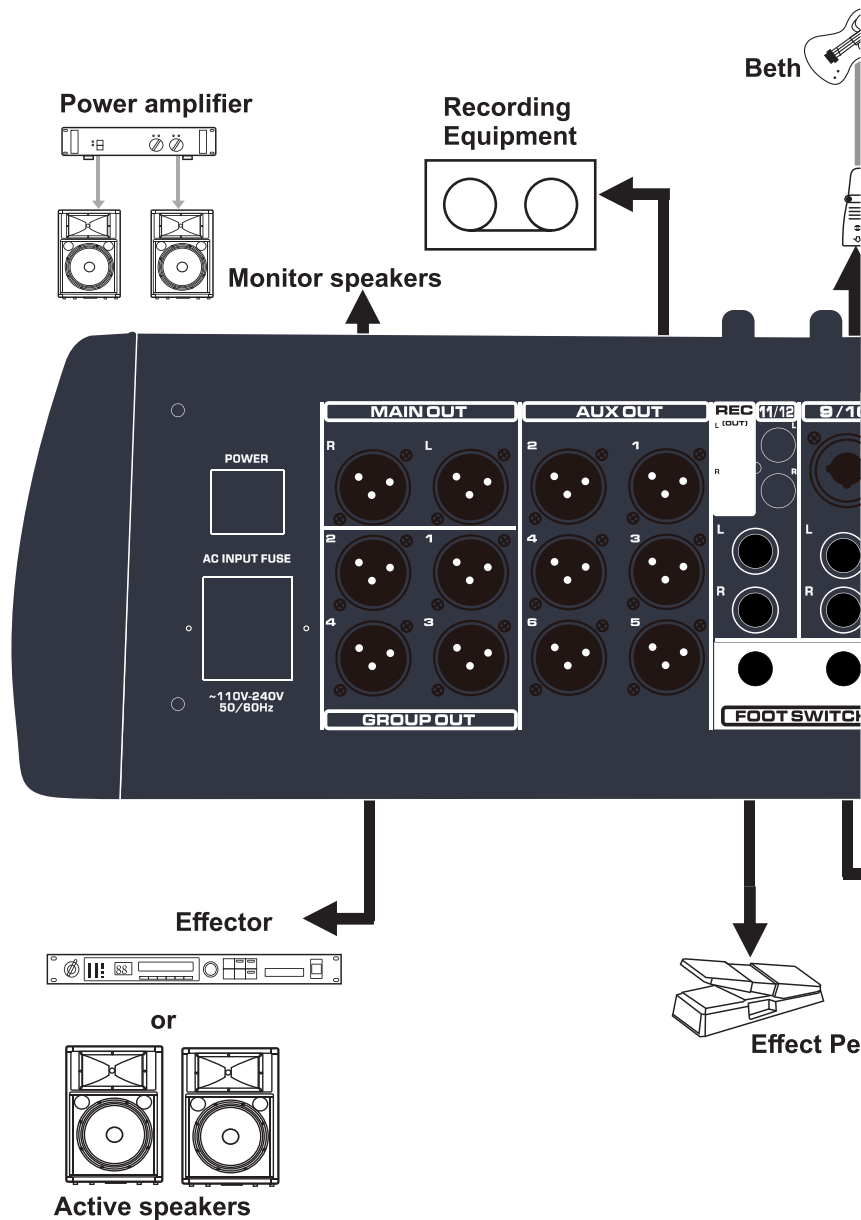

5. Monitor use

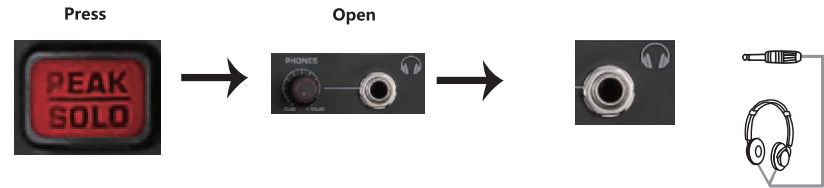

6. REC use

REC is the micro-signal output port of the mixer, which can be connected to a professional recorder or a computer equipped with recording software.

7. USING VOLTAGE

Please note that the mains voltage is 110V--- 240V, If it is lower than 220V, please use a voltage regulator, otherwise the insufficient power supply will cause current noise.

8. Warnings:

To select a mixer equipped with a wireless microphone, please use the penultimate channel control. For example, the third channel of the 4-channel mixer controls the microphone, for example, the seventh channel of the 8-channel mixer. Restore factory settings: You should press PROGRAM at the same time while opening the mixer.

Factory accessories: one host, one power supply, one manual, one warranty card.

2. Use of built-in effects

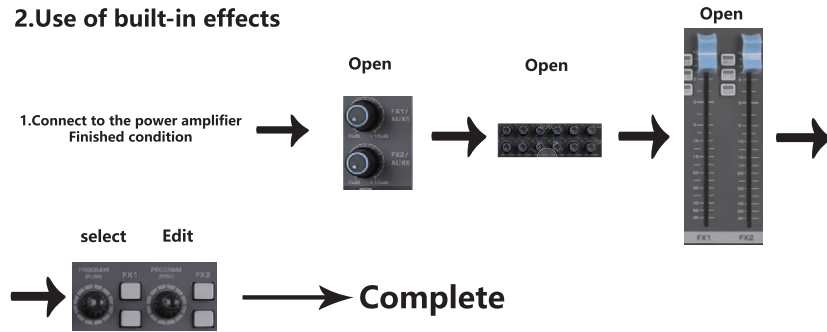

3. Use of AUX

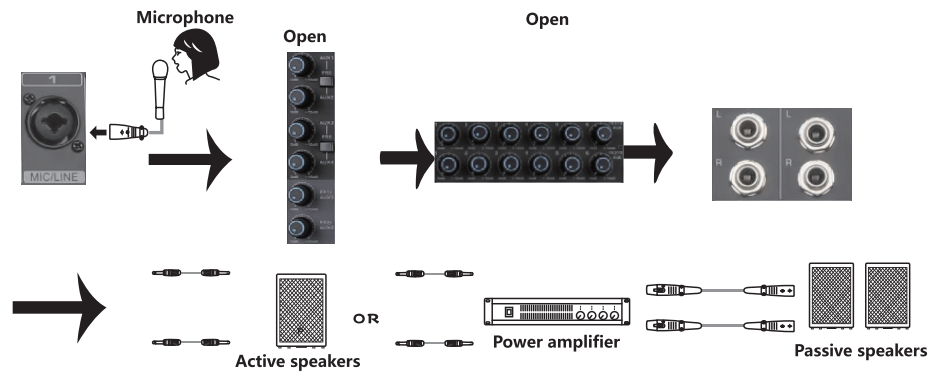

4. Use of USB

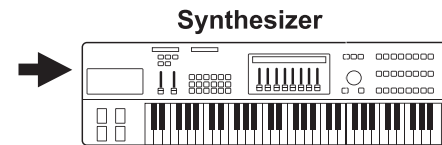
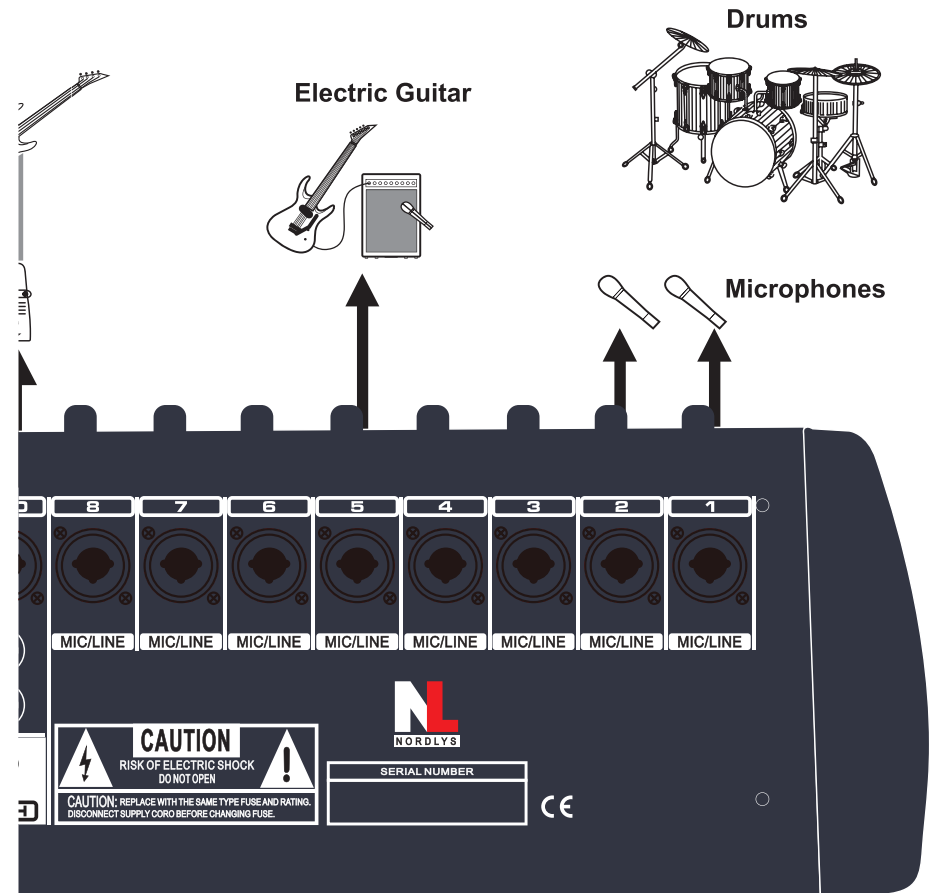
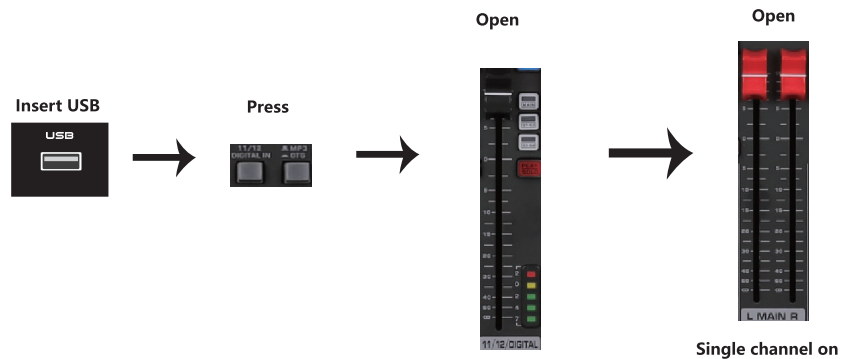

dal

Important safety instructions



Caution !

To reduce the risk of electric shock, do not remove the top cover (or the rear section). No user serviceable parts inside. Refer servicing to qualified personnel

Caution !

To reduce the risk of fire or electric shock, do not expose this appliance to rain and moisture. The apparatus shall not be exposed to dripping or splashing liquids and no objects filled with liquids, such as vases, shall be placed on the apparatus.



This symbol, wherever it appears, alerts you to important operating and maintenance instructions in the accompanying literature. Please read the manual.



This symbol, wherever it appears, alerts you to the presence of uninsulated dangerous voltage inside the enclosure - voltage that may be sufficient to constitute a risk of shock.

Caution !

- [1]. Keep these instructions.
- [2]. Heed all warnings.
- [3]. Follow all instructions.
- [4]. Follow all instructions.
- [5]. Do not use this apparatus near water
- [6]. Clean only with dry cloth.
- [7]. Do not block any ventilation openings. Install in accordance with the manufacturer's instructions.
- [8]. Do not install near any heat sources such as radiators, heat registers, stoves, or other apparatus (including amplifiers) that produce heat.
- [9]. Do not defeat the safety purpose of the polarized or grounding-type plug. A polarized plug has two blades with one wider than the other. A grounding-type plug has two blades and a third grounding prong. The wide blade or the third prong are provided for your safety. If the provided plug does not fit into your outlet, consult an electrician for replacement of the obsolete outlet.

- [10]. Place the power cord so that it is protected from being walked on and sharp edges. Be sure that the power cord is protected particularly at plugs, convenience receptacles and the point where it exits from the apparatus
- [11]. The apparatus shall be connected to a MAINS socket outlet with a protective earthing connection.
- [12]. Where the MAINS plug or an appliance coupler is used as the disconnect device, the disconnect device shall remain readily operable.



- [13]. Only use attachments/accessories specified by the manufacturer.
- [14]. Use only with the cart, stand, tripod, bracket, or table specified by the manufacturer, or sold with the apparatus. When a cart is used, use caution when moving the cart / apparatus combination to avoid injury from tip-over.
- [15]. Unplug this apparatus during lightning storms or when unused for long periods of time.
- [16]. Refer all servicing to qualified service personnel. Servicing is required when the apparatus has been damaged in any way, such as power supply cord or plug is damaged, liquid has been spilled or objects have fallen into the apparatus, the apparatus has been exposed to rain or moisture, does not operate normally, or has been dropped.

Examples of use

1. Use the amplifier

③Choice 1:4ch big power mixer or 2ch big power mixer

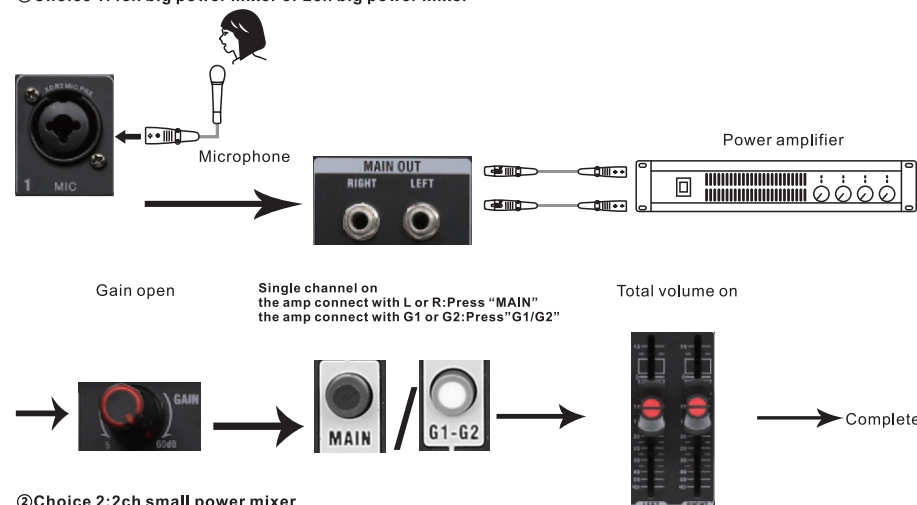

②Choice 2:2ch small power mixer

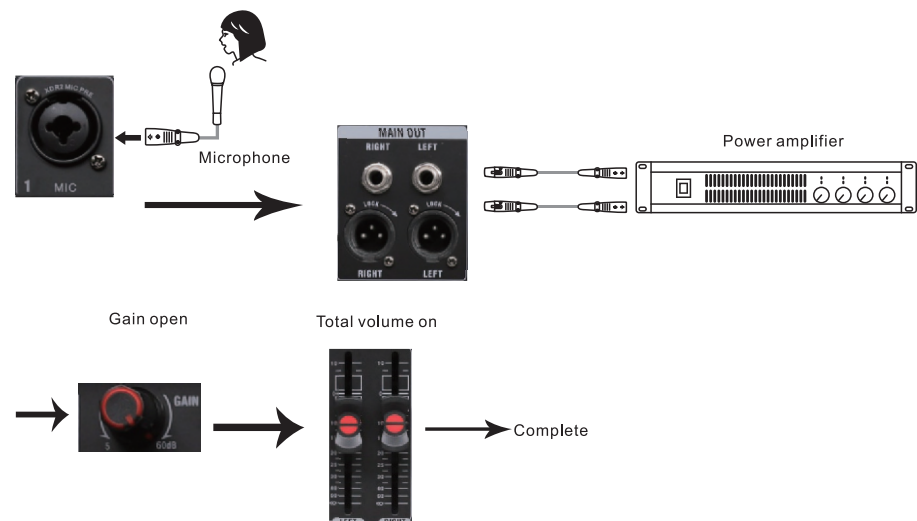

Remark:

There is no sound after pressing "MUTE" key



Please check the "MUTE" key whether press when the channel without any sound.

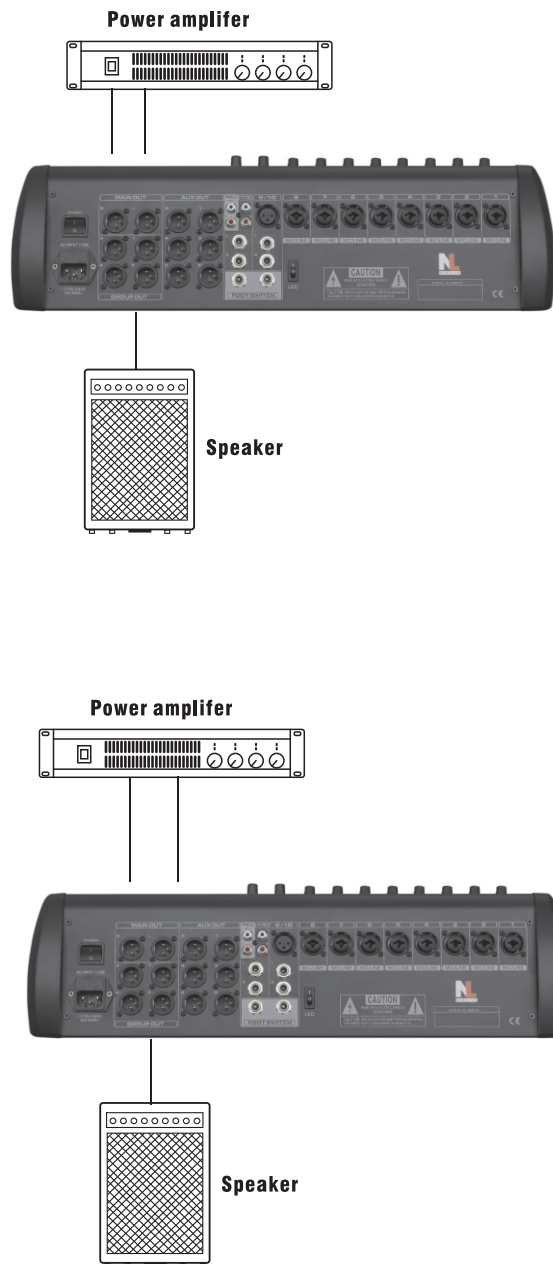

INPUT CHANNELS SECTION

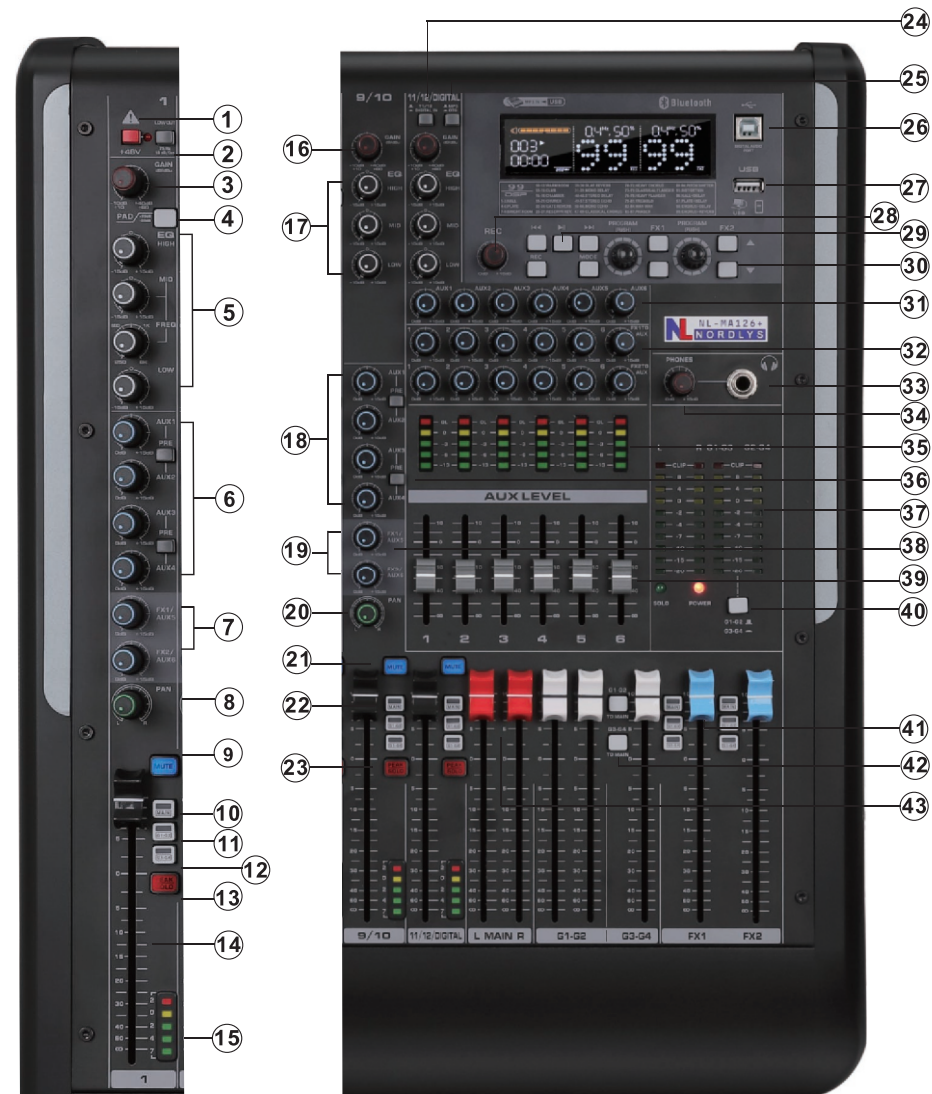

1.PHANTOM +48V SWITCH

This is switch toggles phantom power.Press this key to turn on / off phantom power.

2.LOW CUT: Turn on/off LOW CUT.User should press this switch if you want to open LOW cut. The frequency will cut under 80HZ if you press this key.

3.TRIM CONTROL

Adjusts the input signal level. To get the best balance between the S/N ratio and the dynamic range, adjust the gain so that the PEAK indicator lights only occasionally and briefly on the highest input transients. The 60 to+10 scale is the MIC input adjustment range. The -40 to +10 scale is the Line input adjustments range. The -40 to +10 scale is the LINE input adjustment range.



4.PAD SWITCH

Cut down the signal sensitivity of each channel 20dB

5.Equalizier (HIGH. MID. LOW)

This the four-band equalizer adjusts the channels high. mid and low frequency bands. Setting the knob to the "0"position produces a flat response in the corresponding frequency band, while turning to the left attenuates the band.

6.The PRE 1-3 4-6

The [AUX1] knob indicated "PRE" adjusts the level of the pre-fader signal (before fader adjustment) The [PRE] switch on [AUX1][AUX2] and [AUX3][AUX4] can be used to select whether the pre-fader () (the signal before fader adjustment) or post fader ()(the signal after fader adjustment) signal is sent to the AUX bus by the [PRE] switch.

7.AUX5,AUX6 CONTROL

Controlling the level of the auxiliary output channel without affecting the mixed amplifier signal. Adjusts the level of input channel to AUX.

FX1&FX2 CONTROL

The aux send marked FX offers a direct route to the built-in effects processor. Controlling the EFF volume of mono channel.

8.PAN Control

The PAN control determines the position of the channel signal within the stereo image. When working with sub groups, you can use the PAN control to assign the signal to just one output, which gives you additional flexibility in recording situations.

9.MUTE SWITCH

The accordingly channel will be mute after pressing this key.

10.MAIN

You can use MAIN-L/R fader after pressing "MIX"switch.

11.G1-G2

You can use G1-2 fader after pressing the switch.

12.G3-G4

You can use G3-4 fader after pressing the switch.

13.SOLO/ PEAK SWITCH

SOLO: Folks use solo in live work preview channels before they are let into the mix, or to just check out what a particular channels is up to anytime during a session.You can solo as many channels at a time as you like. All in all, you can monitor according channel with earphone after pressing this key.

49. 9/10 XLR INPUT

Electronically balanced inputs acceptable a standard XLR male connectoer. +48V phantom power available on each input Mic socket. And this switch is on rear phantom power.

50.MIC INPUT JACKS

These are balanced XLR -type microphone input jacks.(1:Ground;2:Hot;3:Cold)

LINE Input jacks(monaural channels)

These are balanced TRS phone-jack line inputs.(T:Hot;R:Cold;S:Ground). You can connect either balanced or unbalanced phone plugs to these jacks.

51.FUSE HOLDER/IEC MAINS RECEPTACLE

The console is connected to the mains via the cable supplied, which meets the required safety standards. Blown fuses must only be replaced by fuses of the same type and rating. The mains connection is made via a cable with IEC mains connector. An appropriate mains cable is supplied with the equipment.

52.GROUP OUT(1-2) JACKS

It could connect with others amplifiers , which could be controlled by GROUP 1-2.

GROUP OUT(3-4) JACKS

It could connect with others amplifiers , which could be controlled by GROUP 3-4.

53.FOOT SWITCH

Connecting with effect pedal.

41.FX LEVEL FADERS

Controlling the level of EFF output signal.

42.MAIN

You could use MAIN L-R fader after pressing "MAIN" switch.

G1-2;G3-4

You can use G1-2 fader after pressing the switch.

You can use G3-4 fader after pressing the switch.

43.CHANNEL LEVEL KNOB- L&R

Adjusts the level of the main output signal.

BACK PANEL SECTION

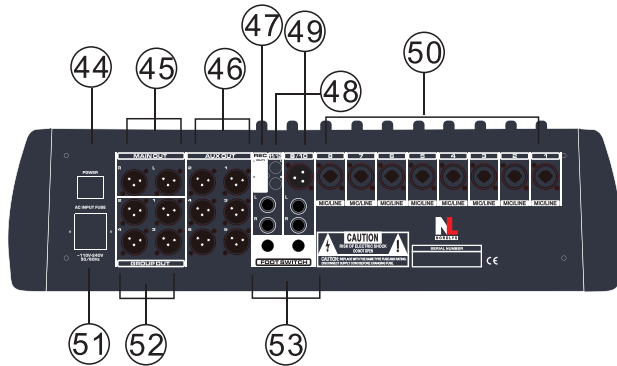

44.POWER SWITCH

Use the POWER switch to turn on the mixing console. The POWER switch always be in the "off" position when you are about to connect your unit to the mains. To disconnect the unit from the mains, pull out the main cord plug. When installing the product, ensure that the plug is easily accessible.

45.MAIN OUT(L,R) JACKS

These jacks deliver the mixer's stereo output. You use these jacks, for example, to connect to the power amplifier driving your main speakers.

46.AUX1-2-3-4-5-6 OUT

The AUX SEND jack should be used when hooking up a monitor power amplifier or active monitor speaker system. The relevant AUX path should be set pre-fader.

47.STEREO OUT JACKS

This jack is to be connected with cassette deck when recording the mixed output.

48.STEREO INPUT JACKS

You can connect with cassette deck.

PEAK: When the input signal is too loud , the indicator will flash.

14.CHANNEL FADERS

Adjusts the level of the channel signal. Using these fader to adjust the output level amount the various

15.INPUT LED DISPLAY

Input signal strength indicator for each mono channel with LED display. Users can observe the input signal strength from here.

16.TRIM CONTROL-STEREO INPUT CHANNEL

Adjusts the input signal level. To get the best balance between the S/N ratio and the dynamic range, adjust the gain so that the PEAK indicator lights only occasionally and briefly on the highest input transients. The 60 to +10 scale is the MIC input adjustment range. The -40 to +10 scale is the Line input adjustments range. The -40 to +10 scale is the LINE input adjustment range.

17.EQUALIZER-STEREO INPUT CHANNEL

This the three-band equalizer adjusts the channels high. mid and low frequency bands. Setting the knob to the "0" position produces a flat response in the corresponding frequency band, while turning to the left attenuates the band.

18.AUX1,AUX2,AUX3,AUX4,AUX5,AUX6 CONTROL

Controlling the level of the auxiliary output channel without affecting the mixed amplifier signal. Adjusts the level of 9/10 channel to AUX.

19.FX1/2 CONTROL

The aux send marked FX offers a direct route to the built-in effects processor. Controlling the EFF volume of 9/10 channel.

AUX5,AUX6 CONTROL

Controlling the level of the auxiliary output channel without affecting the mixed amplifier signal. Adjusts the level of input channel to AUX.

20.PAN Control

The PAN control determines the position of the channel signal within the stereo image. When working with sub groups, you can use the PAN control to assign the signal to just one output,which gives you additional flexibility in recording situations.

21.MUTE SWITCH

The accordingly channel will be I mute after pressing this key.

22.MAIN

You can use MAIN-L/R fader after pressing "MAIN" switch.

G1-2;G3-4

You can use G1-2 fader after pressing the switch.

You can use G3-4 fader after pressing the switch.

23.SOLO/ PEAK SWITCH



SOLO: Folks use solo in live work preview channels before they are let into the main,or to just check out what a particular channels is up to anytime during a session.You can solo as many channels at a time as you like. All in all, you can monitor according channel with earphone after pressing this key.

PEAK: When the input signal is too loud , the indicator will flash.

24.TOGGLE KEY

When the key is released , the input signal for this channel is from 11/12th channel.
When the key is pressed , the input signal for the soundcard input channel.

25.TOGGLE KEY

When the key is released , the input signal for the MP3 input channel.
When the key is pressed , the input signal for the soundcard input channel.

26.SOUNDCARD INPUT PORT

 **PC/PHONE INTERFACE:** Connecting with PC or PHONE.

27.USB INTERFACE :

 Inserting USB to this port.

28.REC volume control

29.THE CONTROLLING ZONE OF Mp3

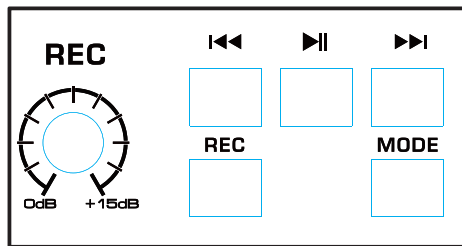

PLAY/PAUSE CONTROL BUTTON

 **PREV** Prev/Volume"- decrease control button.
Short press the key to skip the previous song.
Hold the key for seconds to decrease the master volume.

 Short press to play/stop music.

 **NEXT** Next/Volume"+"increase control button.
Short press the key to skip the next song.
Hold the key for seconds to increase the master volume.

REC Get into recording interface after pressing the key.

MODE Get into recording /BT mode interface after pressing the key.

30.Multi functional zone

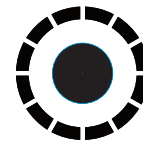
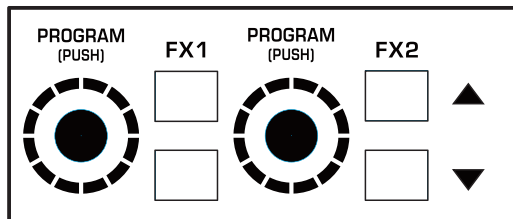

Adjusting the EFF parameters from this knob.

FX2



Selecting the EFF type from these key.

31.AUX1&AUX2&AUX3&AUX4&AUX5&AUX6

Controlling the level of the auxiliary output channel without affecting the mixed amplifier's signal.
Adjusts the level of 11/12 channel to AUX.

32.FX TO AUX

The EFF(FX) could be added into the AUX output if you turn this knob to the right side.

33.PHONES JACK

Connecting a pair of headphones to this TRS phone-type output jack.



34.PHONE LEVEL CONTROL

Controlling the output signal level to headphones.

35.LEVEL METER

Show the level signal's level of AUX output.

36.The PRE 1-3 4-6

The [AUX1] knob indicated "PRE" adjusts the level of the pre-fader signal (before fader adjustment) The [PRE] switch on [AUX1][AUX2] and [AUX3][AUX4] can be used to select whether the pre-fader () (the signal before fader adjustment) or post fader () (the signal after fader adjustment) signal is sent to the AUX bus by the [PRE] switch.

37.LEVEL METER

Show the level signal's strong.



38.AUX5 AUX6 & Fx1 Fx2 CONTROL

Controlling the level of auxiliary output channel without affecting the mixed amplifier signal.
Adjusts the level of input channel to AUX.
Also controlling the EFF volume of mono channel.
The AUX send marked FX offers a direct route to the built-in effects processor.

38.TOGGLE KEY

1-2 

3-4 

When the key is released , users can monitor signal from 1st-2nd of GROUP.
When the key is pressed , users can monitor signal from 3th-4th of GROUP.

39.AUX LEVEL FADERS

Controlling the level of the auxiliary output channel without affecting the mixed amplifier signal.